

VARI-FLEX® XC



Vari-Flex XC combines superb dynamics and comfort for a range of activities. The foot features a shock absorbing dual carbon keel. Lightweight and easy to fit.

The impact reduction and smooth roll-over offered by the Vari-Flex XC are designed to accommodate hiking and jogging, as well as level ground walking – ideal for active people who want to use a single lightweight foot.

Unity for Vari-Flex XC is available either pre-fit with a new foot or as a retrofit option. Used in combination with Iceross® Seal-In® liners, Unity provides advanced vacuum suspension for the socket during ambulation, without the constraints of an external sleeve. It adds minimal weight to the existing prosthesis and its simple mechanical design means there are no batteries to worry about. Reliable, effective and easy to use, it is designed to improve balance and prevent skin problems.



User information	
Amputation Level:	Transfemoral and Transtibial
Impact Level:	Low to High
Maximum Patient Weight:	166kg (365lbs)



PROPORTIONAL RESPONSE



CARBON-X® ACTIVE HEEL



FULL LENGTH TOE LEVER



ACTIVE TIBIAL PROGRESSION



VERTICAL SHOCK PYLON

Foot information	
Categories:	1-9
Size:	22-30
Weight of Foot: (Size 27)	712g w/ Foot Cover and Sock
Build Height: (Size 27)	155mm (6 1/8") w/ Male Pyramid and Foot Cover
Heel Height:	10mm (3/8"), 19mm (3/4") available on special order
Adapter Options:	Male Pyramid

Unity System Information	
Maximum Vacuum:	-23inHg (-600mmHg)
Normal Operating Pressure:	-16-20 inHg
Added System Weight:	122g w/ Pump, Socket Valve and Tube

VARI-FLEX® XC

ORDERING INFORMATION

FOR COMPLETE FOOT



Please select the appropriate Unity Pump Module kit according to foot module size when placing an order and Unity will come preassembled on the foot. For extra convenience and system compatibility, Unity Valve Kits are highly recommended as a means of connecting to the socket.

For liner selection charts and item numbers please refer to the appropriate Icross Seal-In page.

FOR COMPLETE FOOT WITH UNITY

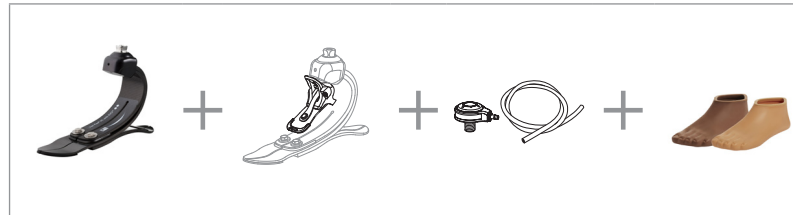

CATEGORY SELECTION CHART

Weight kg	45-52	53-59	60-68	69-77	78-88	89-100	101-116	117-130	131-147	148-166
Weight lbs	99-115	116-130	131-150	151-170	171-194	195-221	222-256	257-287	288-324	325-365
Low Impact Level	1	1	2	3	4	5	6	7	8	9
Moderate Impact Level	1	2	3	4	5	6	7	8	9	N/A
High Impact Level	2	3	4	5	6	7	8	9	N/A	N/A

VARI-FLEX® XC

CLEARANCE

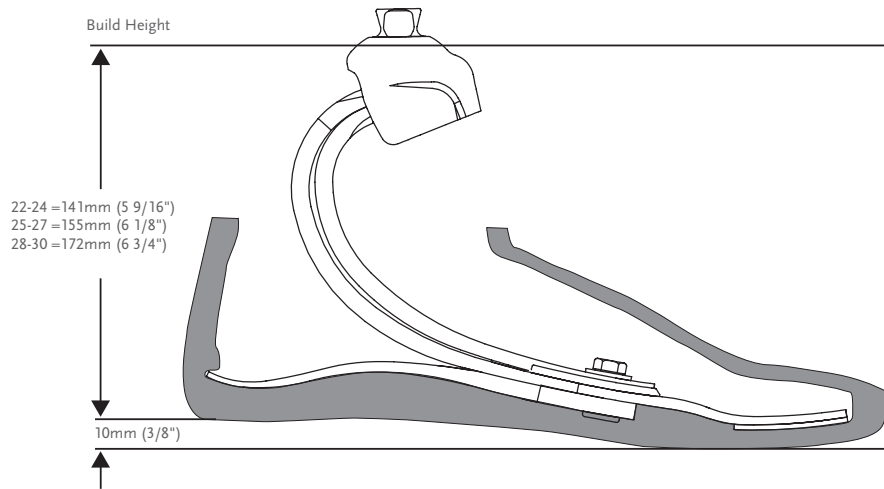

KITS

VARI-FLEX XC WITH MALE PYRAMID

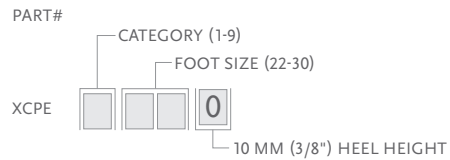

COMPONENTS

HEEL WEDGE KIT

For adjustment of heel stiffness and roll-over characteristics.

Part#	Foot Size
CM150011	22-30

- Includes:
- 3 Wedges
 - Adhesive



HEEL DIVIDER

Heel dividers act to separate the edges of a split heel to reduce wear and noise between the composite elements.

Part#	Description
CM140003	Heel Divider

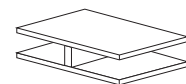

LOCTITE 410 BLACK

Part#	Description
CM160016	Loctite 410 black

VARI-FLEX® XC

UNITY

UNITY KITS

Picture	Part#	Description	Applicable Foot Kits
1	UXC0024	Unity Pump Module XC 22-24	Vari-Flex XC Size 22-24
1	UXC0027	Unity Pump Module XC 25-27	Vari-Flex XC Size 25-27
1	UXC0030	Unity Pump Module XC 28-30	Vari-Flex XC Size 28-30
2	UTT0001	Unity TT Valve Kit	All
3	UTF0001	Unity TF Valve Kit	All
4	UTF0006	Unity TF Tube Kit	All

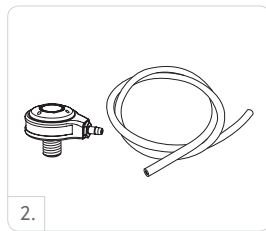
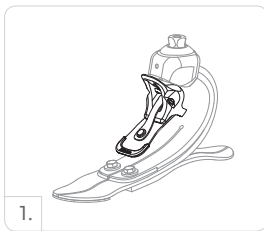

UNITY SPARE COMPONENTS

Part#	Description
UXC00021	Unity XC Components, 22-24
UXC00022	Unity XC Components, 25-27
UXC00023	Unity XC Components, 28-30

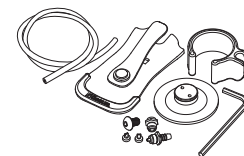

Includes:

- Pump Blade
- Membrane
- Barb Fittings
- Check valves
- Mounting Screw
- Tube
- Loctite
- Hex key

FOOT KITS APPLICABLE WITH UNITY

VARI-FLEX XC WITH MALE PYRAMID

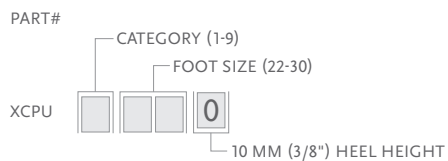

VARI-FLEX® XC

COSMETIC FINISHING

FOOT COVER KIT, BEIGE AND BROWN*

PART#

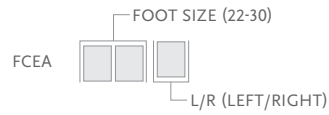

Includes:

- Foot Cover*
- Flex-Foot Sock
- Foot Cover Attachment

*Please specify when ordering brown covers, add "BR" to the end of the part number.

FLEX-FOOT SOCKS

Used to cover the composite foot module to protect the foot and eliminate noise between foot module and foot shell.

Part#	Size
FCE63006	22-25
FCE63007	26-30

